



ROITHNER LASERTECHNIK GmbH

WIEDNER HAUPTSTRASSE 76
TEL. +43 1 586 52 43 -O. FAX. -44

1040 VIENNA
OFFICE@ROITHNER-LASER.COM

AUSTRIA



RLCU-365

- UV SMD LED
- 365 nm, 12 mW
- 3020 Ceramic SMD package
- Beam Angle: $\pm 65^\circ$



Description

RLCU-365 is an ultraviolet surface mount LED, utilizing a AlInGaN based chip with a typical peak wavelength of 365 nm and optical output power of typically 12 mW. **RLCU-365** comes in 3020 ceramic SMD package with flat silicone resin mold.

Maximum Ratings*

Parameter	Symbol	Values		Unit
		Min.	Max.	
Forward Current	I_F		30	mA
Pulse Forward Current ($T_P \leq 100 \mu s$, $D=10\%$)	I_{FP}		100	mA
Reverse Voltage ($I_R = - \mu A$)	U_R	not designed for reverse operation		
Thermal Resistance	R_{THJA}		60	K/W
Operating Temperature	T_{CASE}	- 40	+ 85	$^\circ C$
Storage Temperature	T_{STG}	- 40	+ 85	$^\circ C$
Soldering Temperature ($t_{max.} 10s$)	T_{SLD}		+ 250	$^\circ C$

*Operating close to or exceeding these parameters may damage the device

Electro-Optical Characteristics ($T_{CASE} = 25^\circ C$)

Parameter	Symbol	Conditions	Values			Unit
			Min.	Typ.	Max.	
Peak Wavelength	λ_P	$I_F=20 \text{ mA}$	363		370	nm
Half Width	λ_{Δ}	$I_F=20 \text{ mA}$		8		nm
Forward Voltage	U_F	$I_F=20 \text{ mA}$		3.6	4.2	V
Output Power	P_O	$I_F=20 \text{ mA}$	7	12		mW
Beam Angle	$2\theta_{1/2}$	$I_F=20 \text{ mA}$		130		deg.

Outline Dimensions

3020 SMD

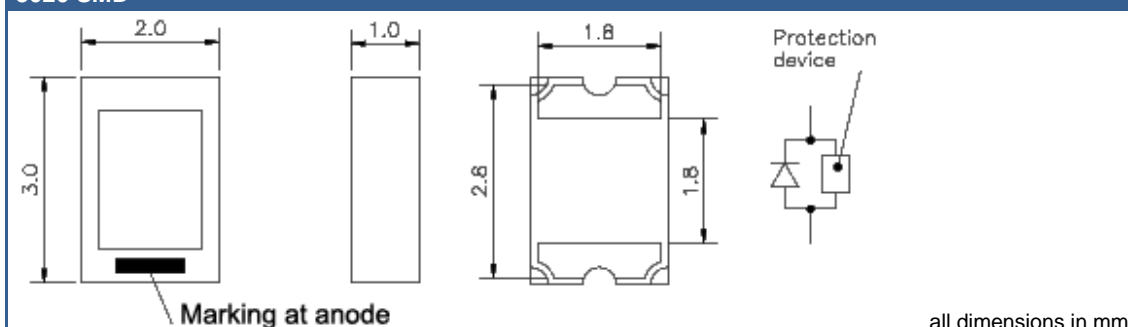



ROITHNER LASERTECHNIK GmbH

WIEDNER HAUPTSTRASSE 76
TEL. +43 1 586 52 43 -O. FAX. -44

1040 VIENNA AUSTRIA
OFFICE@ROITHNER-LASER.COM



Typical Performance Curves

Forward Current vs. Forward Voltage

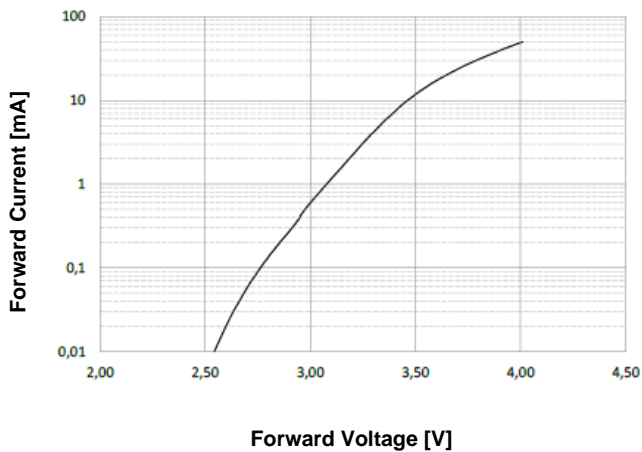

Relative Radiant Intensity vs. Forward Current

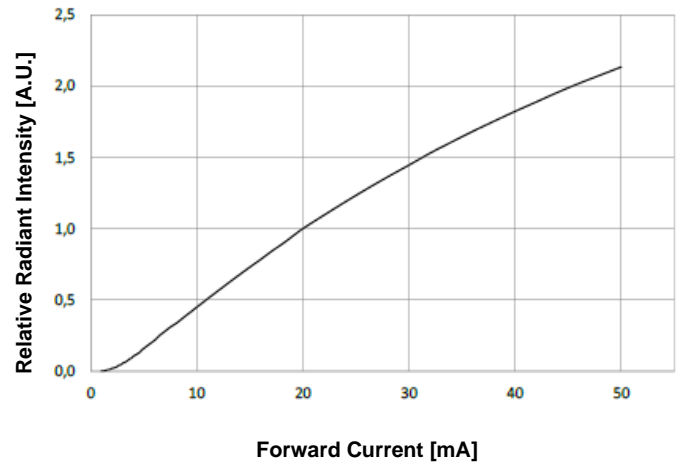

Peak Wavelength vs. Forward Current

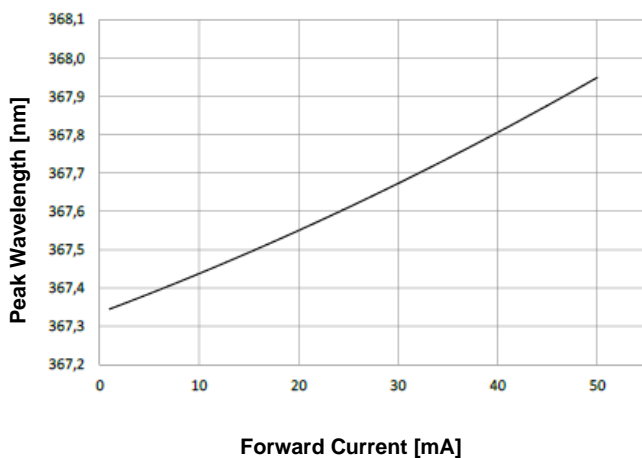

Allowed Forward Current vs. Amb. Temperature

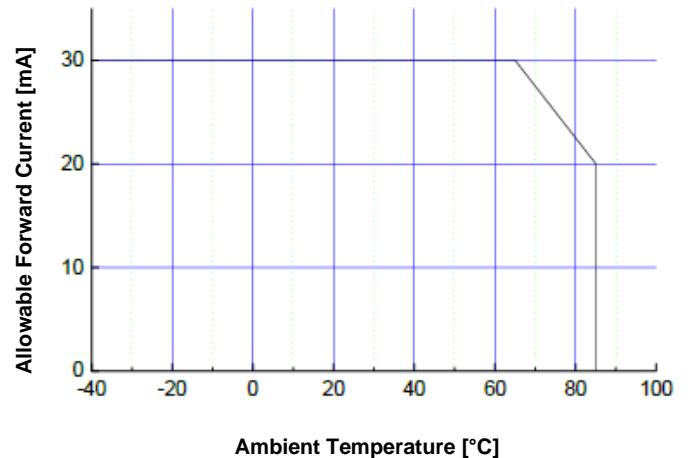

Relative Spectral Emission

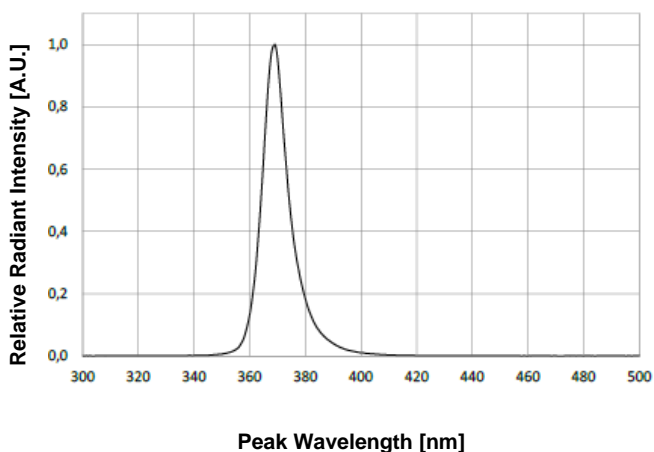

Radiation Characteristics

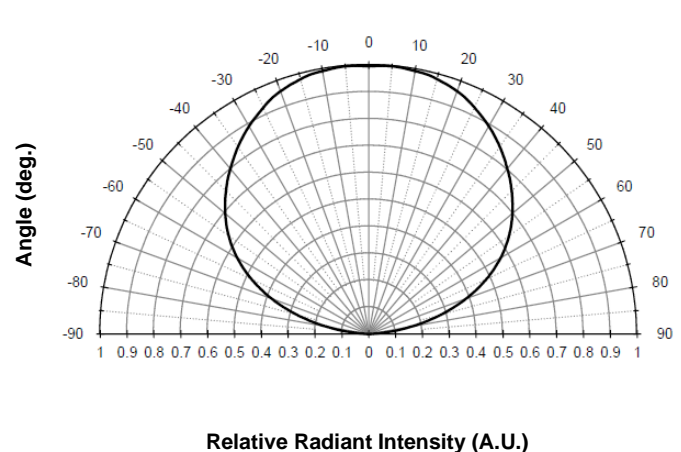



ROITHNER LASERTECHNIK GmbH

WIEDNER HAUPTSTRASSE 76
TEL. +43 1 586 52 43 -0, FAX. -44

1040 VIENNA
OFFICE@ROITHNER-LASER.COM

AUSTRIA



General Notes

Soldering

- Do avoid overheating of the LED
- Do avoid electrostatic discharge (ESD)
- Do avoid mechanical stress, shock, and vibration
- Do only use non-corrosive flux
- Do not apply current to the LED until it has cooled down to room temperature after soldering

Recommended lead free soldering conditions

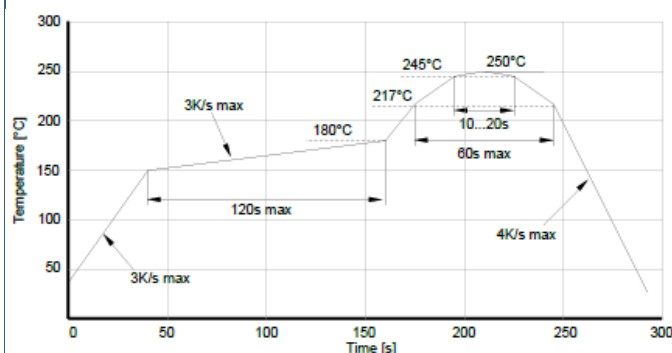

Recommended soldering patterns

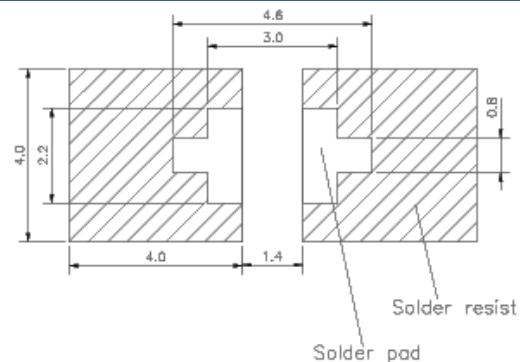

Unit: mm

Cleaning

- **Cleaning with isopropyl alcohol, propanol, or ethyl alcohol is recommended**
- DO NOT USE acetone, chloroform, trichloroethylene, or MKS
- DO NOT USE ultrasonic cleaners

Static Electricity

- **LEDs are sensitive to electrostatic discharge (ESD).**
- Precautions against ESD must be taken when handling or operating these LEDs
- Surge voltage or electrostatic discharge can result in complete failure of the LED.

Radiation

- During operation these LEDs do emit light, which **could be hazardous to skin and eyes**, and **may cause cancer**.
- Do avoid exposure to the emitted light. Protective glasses if needed
- It is further advised to attach a warning label on products/systems.

Operation

- **Do only operate LEDs with a current source.**
- Running these LEDs from a voltage source will result in complete failure of the device.
- Current of a LED is an exponential function of the voltage across it. Usage of current regulated drive circuits is mandatory.

Storage

- The **maximum shelf life** of LEDs in the originally sealed aluminum bag is **12 months**.
- Before opening the aluminum bag, please store it at **<30 °C, <60 % RH**.
- After opening the aluminum bag, please solder the LEDs within **72 hours (floor life)** at **5 – 30 °C, <50 % RH**.
- Put any unused, remaining LEDs and silica gel back in the same aluminum bag and then vacuum-seal the bag.
- It is recommended to keep the re-sealed bag in a desiccator at **<30%RH**.